



USER MANUAL VICTOR 460

Electronic ioniser – Indoor air purifier

Attention! Do not touch needle when unit is turned on!

Function:

By combination of three of the world's most recognized technologies of purification, **AIRBUTLER VICTOR 460** is able to achieve comprehensive purification: dust purification, removal of bacteria and elimination of unpleasant odours. All that can be achieved by means of a very powerful generator of ions. It produces negatively charged ions that are able to remove suspended particles from the air and thus purify the air. Active oxygen is in the position to destroy bacteria, viruses and mites. The power consumption for the mechanics of filtration, purification and for the fan is 27 W only.

Bond of dust:

After a few days of use, you will find a considerable deposit of air pollutants on the different filter systems (such as metal plates) and on the „**PLASMA DUST COLLECTOR**“. Those filter systems purify the air in the interior of the **AIRBUTLER PARKER 460** (by eliminating dirt particles and bacteria even smaller than 0.1 µm). The ionisation wires ensure an enrichment of negatively charged ions in the local air.

Well-being effect:

AIRBUTLER VICTOR 460 removes dust, odours and bacteria within a minimum of time and supports well feeling in general. You can breath fresh and pleasant air.



VICTOR 460



INSTRUCTIONS FOR OPERATION

Locate the appliance on a solid surface. Be sure the grille is not blocked by other objects and that there are no candles or flames near the unit.

Before plugging in the unit, please open the windows in the area where you will be using the unit.

Ventilate the area for 2-3 hours if possible. Once the area has been ventilated, close the windows and plug in the unit. **(Figure 1)**

Plug in. Plug into nearest standard electrical outlet.

Switch on. Press the power button and the appliance starts to operate under AUTO mode.

The colour of clean sign will change alternately for 1 minute, and then the clean sign will revert to current air condition. **(Figure 2)**

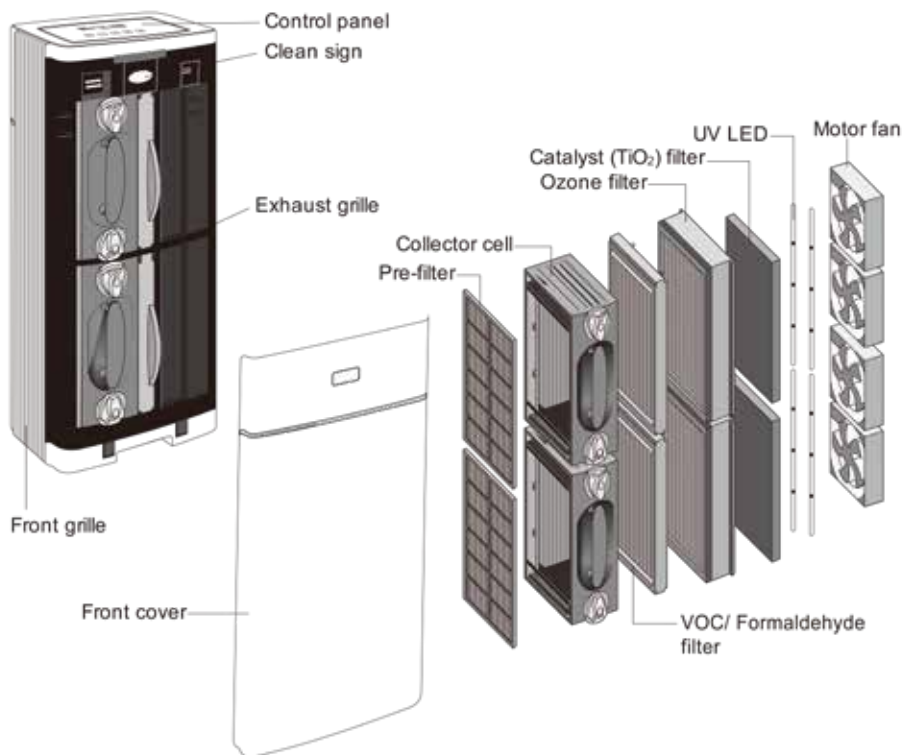

CAUTION!

For first time use or re-operate the appliance after unplug, the sensor needs to be pre-heated for 3-5 minutes and will not respond during this period. Besides, if the current air quality is not good, it is recommended to purify the air manually first and then switch back to AUTO mode, otherwise the sensitivity of the sensor may decrease.

When re-operating the appliance after long period being unused, the sensitivity of the sensor may decrease. It will revert to normal sensitivity after 1-2 days operation.

CONTROL PANEL INSTRUCTIONS

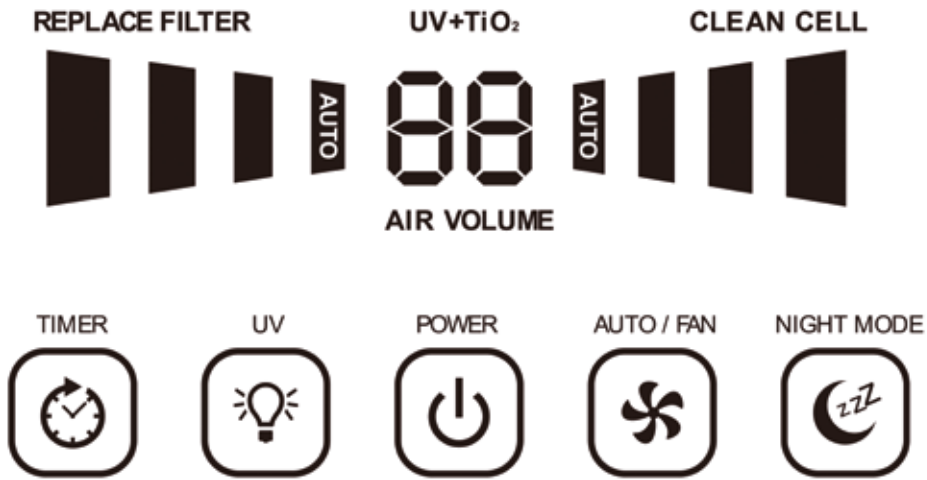

A) ON/ OFF BUTTON

By pressing **BUTTON A** once, you can switch on the unit and the display screen will illuminate. The appliance will start to operate under **AUTO MODE**. By pressing it twice, the unit is switched off.

B) AUTO MODE / FAN SPEED

By repeated pressing of **BUTTON B** you can adjust the air fan speed or operate under **AUTO MODE**. Symbol I shows which of the four levels have been selected:

- **AUTO MODE**
- **Low for silent mode**
- **Medium for normal use**
- **High for maximum cleaning**

Once the **AUTO MODE** is activated, appliance will automatically sense and adjust the air cleaning speed once it detects pollutants in the air.

C) OPERATION WITH CATALYST

BUTTON C is used for switching the catalyst on and off (Symbol "UV+TiO " lights up). This appliance combines advanced catalytic technologies to reduce odours and chemical fumes from glues, solvents and synthetic materials when air passes through the filter and is activated by the internal UV LED. (The catalyst system cannot be removed). If turned off, the appliance will continue filtering particles from the air that passes through the filter but its odour and VOC capability will be significantly reduced.

D) TIMER

Using **BUTTON D**, the operation time can be set. It is selectable between 1~9 hours or continuous operation (continuous), Symbol J shows the operating period that has been set (1h/2h/3h/4h/5h/6h/7h/8h/9h/continuous).

E) NIGHT MODE

By pressing the **BUTTON E** once, the night mode is switched on which automatically dims the display brightness. The appliance continues operating in silent mode. If **BUTTON E** is pressed again, the appliance will no longer be in night mode.

F) CLEANING INDICATOR

If red "CLEAN CELL" indicator appears on the display, the appliance should be cleaned as recommended by the manufacturer. When the collector cell is re-installed after cleaning, switch on the appliance and keep pressing the **BUTTON E** at least 3 seconds until buzzer beeps, red "CLEAN CELL" indicator disappears and "CLEAN CELL" timer is reset.

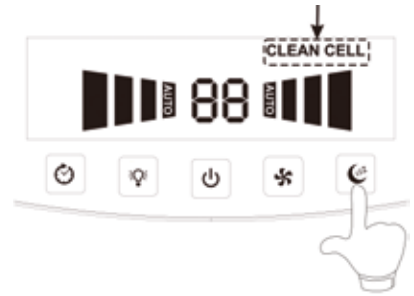

G) CATALYST INDICATOR

Informs about the operation mode of the catalyst.

H) REPLACE INDICATOR

When red "REPLACE FILTER" indicator appears on the display, the VOC/Formaldehyde filter should be replaced as recommended by the manufacturer.

Reset "REPLACE FILTER"

When the VOC/Formaldehyde filter is re-installed after replacement, switch on the appliance and keep pressing the **BUTTON D** at least 3 seconds until buzzer beeps, red "REPLACE FILTER" indicator goes out and "REPLACE FILTER" timer is reset.

I) FAN SPEED INDICATOR

Symbol I shows which of the four levels have been selected:

Low: for silent mode

Medium: for normal use

High: for maximum cleaning

AUTO MODE: Once the **AUTO MODE** is activated, appliance will automatically sense and adjust the air cleaning speed once it detects pollutants in the air. Additionally 4 stages of clean sign, clearly shows your current air condition accordingly.

Green: Clean

Light Orange: Low pollution

Orange: Medium pollution

Red: High pollution

J) TIMER INDICATOR

Shows the operating period that has been set (1h/2h/3h/4h/5h/6h/7h/8h/9h/ circulated). The display will automatically show the current value after a few seconds.

CLEANING AND MAINTENANCE

CLEANING

When the red “CLEAN CELL” indicator is blinking, please restart your appliance. If the red “CLEAN CELL” indicator is still blinking, please clean your collector cell. When the red “CLEAN CELL” indicator illuminates or collector cell is too dirty or if snapping sounds become frequent, please clean your collector cell.



Proper care and cleaning of the air purifier is critical to performance. The following chart shows the cleaning intervals and method.

PLEASE FOLLOW YOUR USER'S GUIDE TO CLEAN.

Cabinet:	<i>As needed</i> Wipe with damp cloth first. If required, follow with mild non-abrasive cleaner.
Collector Cell:	<i>4 to 8 weeks</i> Spray specialized cleaner or soak in warm water or warm water with mild liquid detergent. Rinse and dry.
Pre-Filter:	<i>2 to 4 weeks</i> Rinse thoroughly in warm water or as needed.
Air Direction Grille:	<i>As needed</i> Use the brush provided with the air purifier to brush away debris in between the slots.
VOC/ Formaldehyd Filter:	<i>6 to 12 month or as needed</i> Replace with a new filter.



WARNING!

Cleaning the unit while it is plugged in may result in electric shock, electric spark and serious injury. Unplug the unit before cleaning or maintenance.

CLEANING THE PRE-FILTER

1. Unplug the appliance.
2. Open the front cover by gently pulling from the top corners.
3. Pull the pre-filter straight out of the cabinet.
4. Thoroughly rinse the pre-filter and let it air dry before placing it back in the cabinet. Do not use heated or compressed air as part of the drying process.
5. Slide the pre-filter back into the unit.
6. Close the front cover securely.





CAUTION!

***The collector cell may not require cleaning if “arcing” occurs. Arcing is a sharp snapping sound that occurs when large particles are collected in the collector cell or the appliance used in overdamp rooms.
If prolonged or continuous arcing occurs, the collector cell should be cleaned.***

CLEANING THE COLLECTOR CELL

1. Unplug the appliance.
2. Open the front cover by gently pulling from the top corners.
3. Remove the collector cell by unlocking top and bottom knobs and pulling straight out.
4. Separate the collector cell from the wire assembly for easier access to each during cleaning.
5. Place each in sink, bathtub or other location where cleaner can cover every surface.
6. Spray specialized cleaner between each cell plate and cover each surface. Allow the cleaner to soak for a few minutes but do not let it dry. Thoroughly rinse the collector cell with clean water.

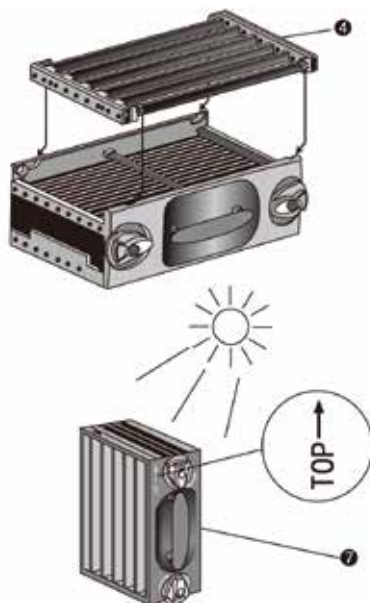

An alternative method to clean the collector cell is to rinse or soak it in warm water for loose debris. Mild liquid dish detergent in water may also be used to help break down tough dirt and residue. Thoroughly rinse the collector cell with clean water.

7. Place the collector cell under the sunlight to dry at least 3 hours. Shake excess water from the collector cell to speed up drying time. Do not use heated or compressed air to dry.
8. Reassemble the wire assembly and collector cell by inserting the post located on the outside edge of the wire assembly into the recessed channels of the collector cell. After guiding the post into the recessed channels, slide the wire assembly until it locks into place.
9. Place the collector cell back into the unit by sliding it straight in and turning each knob to its locking position. The collector cell is specially designed so that it can only be inserted in one direction.
10. Close the front cover securely.



Note: Please refer to instructions on page 16 for resetting after cleaning, otherwise the indicator will remain on screen.



CAUTION!

***To prevent damage to the components of the collector cell, do not put in dishwasher or use acotton swab.
Tough residue such as tar from tobacco smoke may need additional cleaning or longer soaking.***

CLEAN CELL INDICATOR IS BLINKING

The collector cell must be completely dry after cleaning in order to operate properly. In case the residual water left in the collector cell gap, the red "CLEAN CELL" indicator will blink rapidly once operation.

In this case, please re-dry the collector cell under the sunlight, and then restart the appliance. If the red "CLEAN CELL" indicator is off, the appliance will return to original and run as normal. If not, please repeat above method to re-dry until the red "CLEAN CELL" indicator is off.

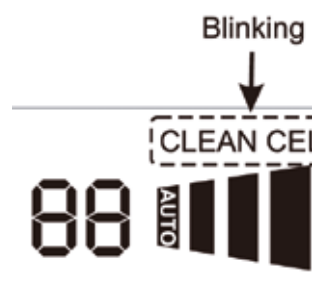

REPLACE THE VOC/ FORMALDEHYDE FILTER

1. Unplug the appliance.
2. Open the front cover by gently pulling from the top corners.
3. Pull the formaldehyde filter straight out of the cabinet.
4. Replace with a new filter.
5. Close the cover securely.

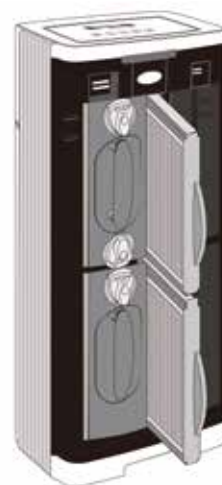

Note: Please refer to instructions on page 16 for resetting after cleaning, otherwise the indicator will remain on screen.

CLEANING THE EXHAUST GRILL

1. Remove the cleaning brush from the storage slot located under the front cover.
2. Brush away debris that has collected between the grille slots.
3. Return the cleaning brush to the storage slot.

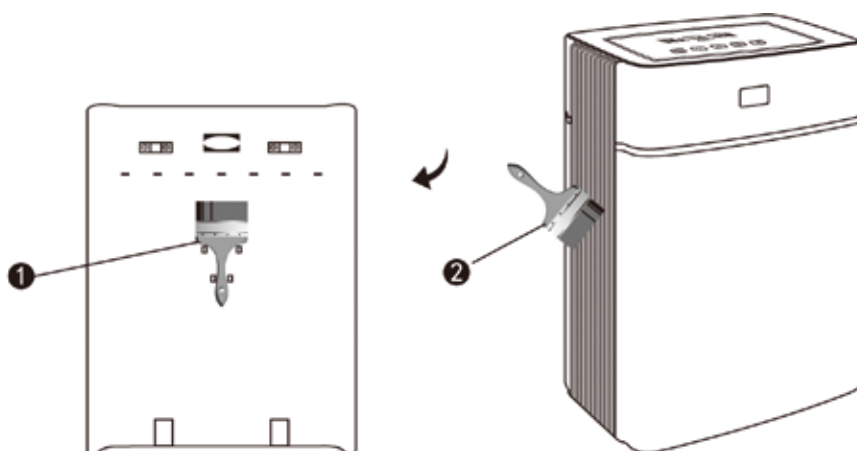

TROUBLESHOOTING

Service problems that appear to be major can often be solved easily. You can be your own troubleshooter by reviewing this guide. All other servicing should be done by a local authorized service center.

PROBLEM	CHECK	SOLUTION
Appliance does not turn ON	<i>Power cord</i> <i>Power button</i> <i>Front cover</i>	<ul style="list-style-type: none"> ■ Plug in power cord ■ Press the POWER BUTTON ■ Make sure the front cover is securely closed
Red "CLEAN CELL" indicator has illuminated	<i>Collector cell</i>	<ul style="list-style-type: none"> ■ Please wash collector cell and reset the timer. <i>Refer to instructions on page 16.</i>
Red "REPLACE FILTER" indicator has illuminated	<i>Filter</i>	<ul style="list-style-type: none"> ■ Please replace filters and reset the timer. <i>Refer to instructions on page 16.</i>
Red "CLEAN CELL" indicator is blinking	<i>Collector cell</i>	<ul style="list-style-type: none"> ■ When a large particle is captured in the collector cell, please restart your appliance. ■ A fast blinking light indicates the collector cell is not properly installed, please reinstall the collector cell. ■ A fast blinking light indicates the power supply has shut down due to arcing or short circuit. The cell should be inspected and cleaned, repaired or replaced. ■ The collector cell is not completely dry after cleaning, please re-dry it.
Collector cell does not remove particles	<i>Collector cell</i>	<ul style="list-style-type: none"> ■ Clean the collector cell. ■ Collector cell may be damaged. <i>Contact authorized service center.</i>
Appliance sparks, crackles and pops.	<i>Collector cell</i>	<ul style="list-style-type: none"> ■ Sparking or popping noise (arcing) can occur when a large particle is captured in the collector cell or appliance is used in over damp rooms. ■ If the appliance is arcing excessively, the cell may be dirty. Try cleaning the collector cell. ■ If excessive arcing continues after proper cleaning, the collector cell may be damaged. <i>If damaged, contact authorized service center</i>
"AUTO" indikator is blinking	<i>Surroundings</i>	<ul style="list-style-type: none"> ■ Air quality is bad, please open the window to improve the ventilation.
"AUTO" indikator is blinking	<i>Sensor</i>	<ul style="list-style-type: none"> ■ Sensor get malfunction, should be repaired or replaced.

SPECIFICATIONS

- High performance DC fan, low energy consumption, durable use.
- Night operating mode, quiet and comforting.
- Built-in smart sensor, automatic sensing and adjust airflow speed, intelligent operation.
- Plasma electrostatic dust collector, easy to clean, never needs to be replaced.
- Large volumes of air rapidly circulate and purify air.
- High performance filter effectively removes extra fine particles of 0.1 - 0.3 microns.
- Negative ions and activated oxygen rapidly remove odour and smoke to freshen the air.
- UV LED is energy-saving, effectively sterilize and kill bacteria.
- Multiple professional filters effectively remove harmful gases like acetone and benzene etc.

SAFETY INSTRUCTIONS

Only use the appliance indoors and within the parameters stated in the technical specifications.

- Using the appliance for a purpose for which it is not intended could pose a serious hazard to health and life. Children cannot realize the hazards associated with the usage of electrical appliances. For this reason, always supervise children when they are near the appliance.
- Never use the appliance if there is any damage to the appliance or cable, after malfunction has occurred, after the appliance has been dropped or damaged in any other way.
- Repairs to electrical appliances may only be carried out by qualified service engineers.
- Improper repair work can pose a serious hazard to the user.
- Do not run the power cord under a carpet or other objects. Position the appliance so that you will not trip over the cord.
- Do not handle the unit with wet hands. Never pull the plug from the mains socket by the cable or with wet hands.
- Hair, loose clothing and body parts can get caught in the machine resulting in injury. Keep hair, loose clothing and body parts away from openings and moving parts.
- Do not use an extension cord.
- Do not place the appliance near sources of heat such as: stove tops, ovens, radiators or computers.
- Do not place open flames, including candles, directly in front of the air purifier.

- Do not use the appliance in an enclosed space where flammable, combustible or explosive gases are present.
- Do not use in an area where toxic vapours, flammable dust or oxygen tanks are present. Check the location and make sure these elements are not present.
- This equipment should be inspected frequently and the dirt that has collected should be removed regularly to prevent excessive accumulation that may result in flashover or fire.
- Do not insert foreign objects from the front grille, high voltage inside.
- Do not defeat interlock.
- Place the appliance on a flat, solid, stable surface. Never place the unit on soft surfaces such as a bed or sofa.
- It is important to keep all objects away from the front and exhaust grille, keep at least 30cm distances.
- Place the appliance away from TV, computer or radio, keep at least 100cm distances.
- Do not use the appliance on wet surfaces or use it in damp locations, such as bathroom.
- Do not sit, stand or place any heavy objects on the appliance.
- Position the appliance so that the dirty air is not drawn across your head or body while sitting or sleeping.
- Place the appliance so the plug on the power cord easily reaches a standard electrical outlet for a polarized plug.
- This appliance is not a substitute of daily ventilation and cleaning or kitchen ventilation.
- Please unplug the appliance if the power cord or plug gets heated, burned smell or weird noise.

WARRANTY

1. All **AIRBUTLER** products are subjected to stringent testing before they leave the factory. Guarantee of function for two years from date of purchase.
2. Damage and malfunctions within the warranty period are only dealt with on presentation of the completed warranty certificate. Please return the appliance to the trader so that the cause of malfunction can be identified. If the damage or malfunction is due to a production fault then the appliance will be repaired immediately or replaced with a new appliance. Damage which is not due to a production fault cannot be taken into account.
3. The warranty does not include any damage due to incorrect handling, faulty reassembly, manual conversion in or on the appliance, omission of cleaning, exterior damage to the appliance or obvious damage to the interior of the casing (such as e.g. lightning, artificial cause or natural events).
4. The date on the warranty certificate and submission of the bill are imperative for any warranty claims.



Name:

Adresse:

Purchase date:

Phone:

Stamp of trader:

We are at your service for questions or application problems: office@airbutler.com

SPECIFICATIONS VICTOR 460

Model	AP-C460A
Related Voltage	AC 240V/50~60Hz
Power	27 W
Activated Oxygen Output	≤ 0.05 ppm
Noise (max)	66db(A)
CADR Value	370m ³ /h
Dimensions	362 x 231 x 830 mm
Net Weight	14,5 kg
Room Size	40~80m ²